

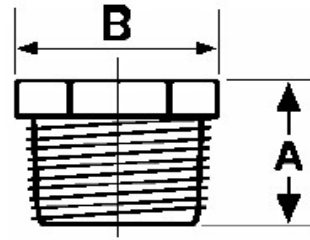

Hex Reducing Bushings

150#, 316 Stainless Steel

Inches / Pounds



Part #	Size	A	B	Approximate Weight (in Lbs.)	Hex
KHB.25X.125SS	1/4 x 1/8	0.89	0.69	0.04	Out
KHB.375X.125SS	3/8 x 1/8	0.91	0.87	0.07	Out
KHB.375X.25SS	3/8 x 1/4	0.91	0.87	0.05	Out
KHB.5X.125SS	1/2 x 1/8	0.99	1.00	0.09	Out
KHB.5X.25SS	1/2 x 1/4	0.99	1.00	0.09	Out
KHB.5X.375SS	1/2 x 3/8	0.99	1.00	0.05	Out
KHB.75X.125SS	3/4 x 1/8	1.02	1.24	0.16	Out
KHB.75X.25SS	3/4 x 1/4	1.02	1.24	0.15	Out
KHB.75X.375SS	3/4 x 3/8	1.02	1.24	0.15	Out
KHB.75X.5SS	3/4 x 1/2	1.02	1.24	0.13	Out
KHB1X.125SS	1 x 1/8	1.30	1.52	0.26	Out
KHB1X.25SS	1 x 1/4	1.30	1.52	0.25	Out
KHB1X.375SS	1 x 3/8	1.30	1.52	0.24	Out
KHB1X.5SS	1 x 1/2	1.30	1.52	0.22	Out
KHB1X.75SS	1 x 3/4	1.30	1.52	0.17	Out
KHB1.25X.125SS	1 1/4 x 1/8	1.30	1.81	0.35	Out
KHB1.25X.25SS	1 1/4 x 1/4	1.30	1.81	0.36	Out
KHB1.25X.375SS	1 1/4 x 3/8	1.30	1.81	0.35	Out
KHB1.25X.5SS	1 1/4 x 1/2	1.30	1.81	0.35	Out
KHB1.25X.75SS	1 1/4 x 3/4	1.30	1.81	0.28	Out
KHB1.25X1SS	1 1/4 x 1	1.30	1.81	0.26	Out
KHB1.5X.25SS	1 1/2 x 1/4	1.38	2.03	0.52	Out
KHB1.5X.375SS	1 1/2 x 3/8	1.38	2.03	0.52	Out
KHB1.5X.5SS	1 1/2 x 1/2	1.38	2.03	0.51	Out
KHB1.5X.75SS	1 1/2 x 3/4	1.38	2.03	0.49	Out
KHB1.5X1SS	1 1/2 x 1	1.38	2.03	0.45	Out
KHB1.5X1.25SS	1 1/2 x 1 1/4	1.38	2.03	0.34	Out
KHB2X.25SS	2 x 1/4	1.42	2.46	0.77	Out
KHB2X.375SS	2 x 3/8	1.42	2.46	0.80	Out
KHB2X.5SS	2 x 1/2	1.42	2.46	0.77	Out
KHB2X.75SS	2 x 3/4	1.42	2.46	0.75	Out
KHB2X1SS	2 x 1	1.42	2.46	0.77	Out
KHB2X1.25SS	2 x 1 1/4	1.93	3.15	0.70	Out
KHB2.1.5SS	2 x 1 1/2	1.93	3.15	0.57	Out
KHB2.5X.5SS	2 1/2 x 1/2	1.93	3.15	1.26	Out

Pipe Fitting Direct
 690 Craig Rd
 Edgerton, WI 53534
 Phone: (608) 371-9313
 Email: sales@pipefittingdirect.com



Hex Reducing Bushings

150#, 316 Stainless Steel

Inches / Pounds

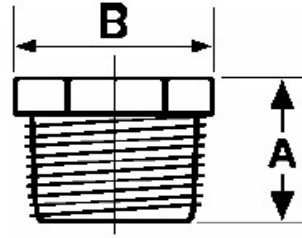

	Size	A	B	Approximate Weight (in Lbs.)	Hex
KHB2.5X.75SS	2½ x ¾	1.93	3.15	1.32	Out
KHB2.5X1SS	2½ x 1	1.93	3.15	1.40	Out
KHB2.5X1.25SS	2½ x 1¼	1.93	3.15	1.40	Out
KHB2.5X1.5SS	2½ x 1½	1.93	3.15	1.23	Out
KHB2.5X2SS	2½ x 2	1.93	3.15	0.99	Out
KHB3X.5SS	3 x ½	1.95	3.76	2.12	Out
KHB3X.75SS	3 x ¾	1.95	3.76	2.08	Out
KHB3X1SS	3 x 1	1.90	3.76	2.17	Out
KHB3X1.25SS	3 x 1¼	1.95	3.76	2.20	Out
KHB3X1.5SS	3 x 1½	1.95	3.76	2.10	Out
KHB3X2SS	3 x 2	1.95	3.76	1.90	Out
KHB3X2.5SS	3 x 2½	1.95	3.76	1.61	Out
KHB4X1SS	4 x 1	2.01	4.74	3.64	Out
KHB4X1.25SS	4 x 1¼	2.01	4.74	3.50	Out
KHB4X1.5SS	4 x 1½	2.01	4.74	3.61	Out
KHB4X2SS	4 x 2	2.01	4.74	3.52	Out
KHB4X2.5SS	4 x 2½	2.01	4.74	3.40	Out
KHB4X3SS	4 x 3	2.01	4.74	2.83	Out

***Stainless Steel Castings conform to ASTM A351 ACI Grade CF8M (316)**

***NPT Threads on all fittings conform to ASME B1.20.1**